

LED Garden Light Specification

YB-TP500 Series



I . Application :

Pedestrian street, factory, schools, garden, courtyard, hotel, parking lot, public park etc.

II . Features:

1. Lighter in weight. High cost performance.
 2. Different precision refractive optical lens designed for various applications. Using high brightness Samsung led chips and high quality Mean Well driver .
 3. IP65 suitable for wet locations.
 4. Environment friendly. Contains no lead or mercury.
 5. Warranty: 5 years.
 6. DIALUX simulation design available.
-

LED Garden Light Specification

YB-TP500 Series

III. Product Size(mm):

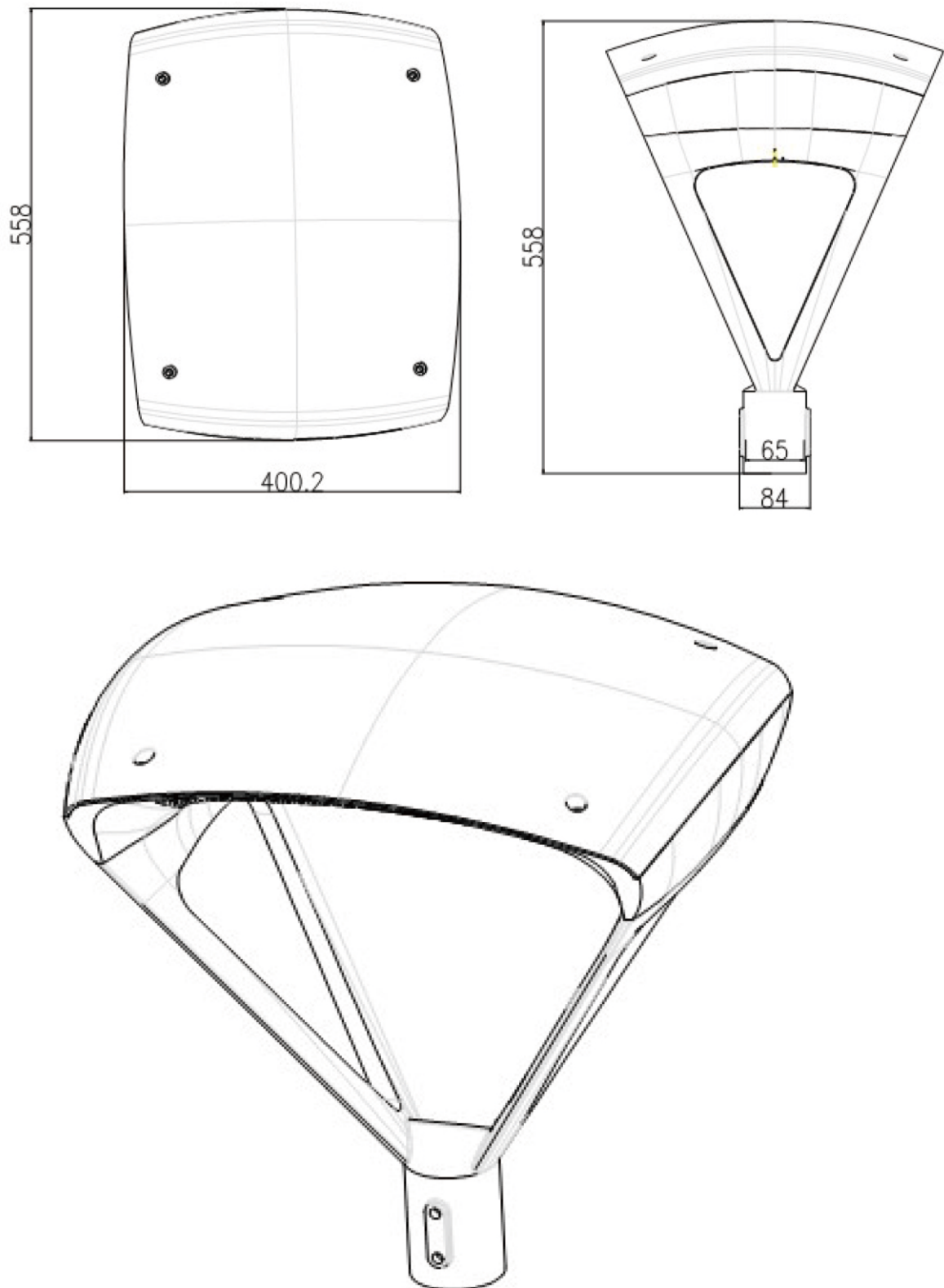

LED Garden Light Specification

YB-TP500 Series

IV. Technical Parameter:

Model	CCT	CRI	Flux	Size (MM)	System Power
YB-PT500-W50	3000K/4000K/5000K/ 6000K/7000K	≥70	6500LM	558*400*558	50±5 W
YB-PT500-W100	3000K/4000K/5000K/ 6000K/7000K	≥70	13000LM	558*400*558	100±5 W
YB-PT500-W150	3000K/4000K/5000K/ 6000K/7000K	≥70	19500LM	558*400*558	150±5 W
YB-PT500-W200	3000K/4000K/5000K/ 6000K/7000K	≥70	26000LM	558*400*558	200W±5 W
YB-PT500-W300	3000K/4000K/5000K/ 6000K/7000K	≥70	39000LM	558*400*558	300W±5 W
Input Voltage: 100-277Vac or 180-528vac					
LED CHIP:Philips Lumileds 3030					
LED driver:SOSEN / MEANWELL					
Working temperature: - 30 ~ + 50°C					

V. Beam Angle:

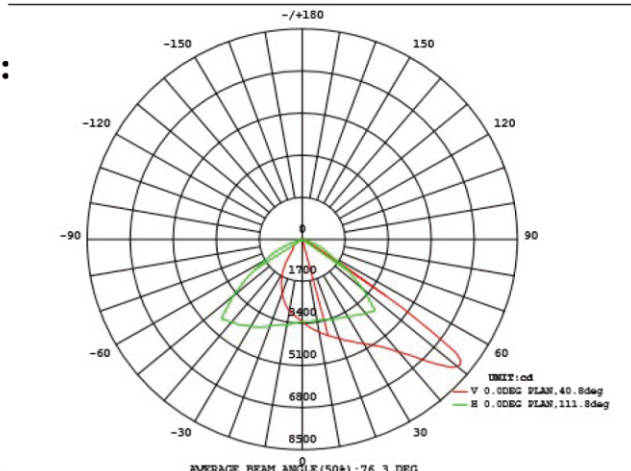

Type III 90*140Deg

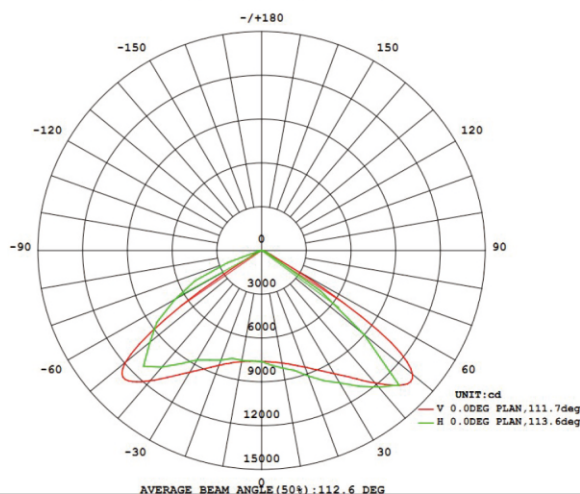

Type V 120Deg

LED Garden Light Specification

YB-TP500 Series

VI. Installation Instruction

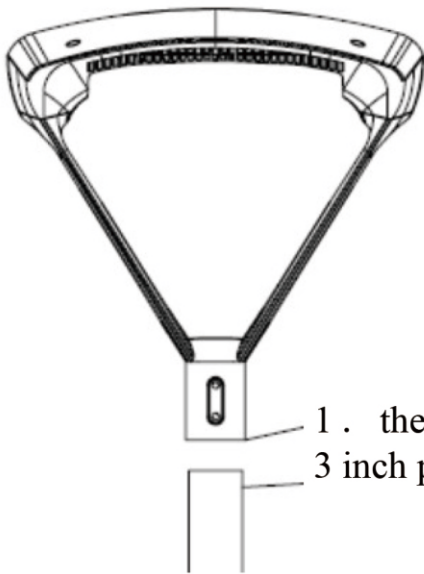

1 . the Light will fit on 2 3/8 inch or 3 inch pole or tenon

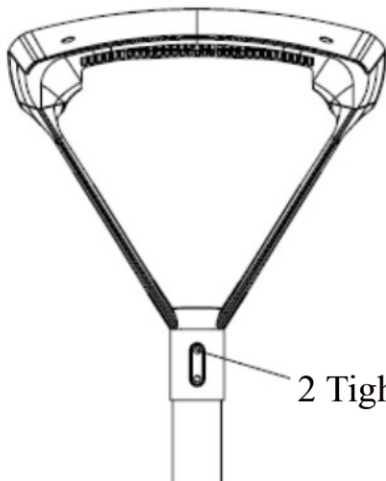

2 Tighten the M8 screws.

3 Connect the power lines.



Dimmable cable
Blue is “+”
White is “-”



LED Garden Light Specification

YB-TP500 Series

Photocell sensor available

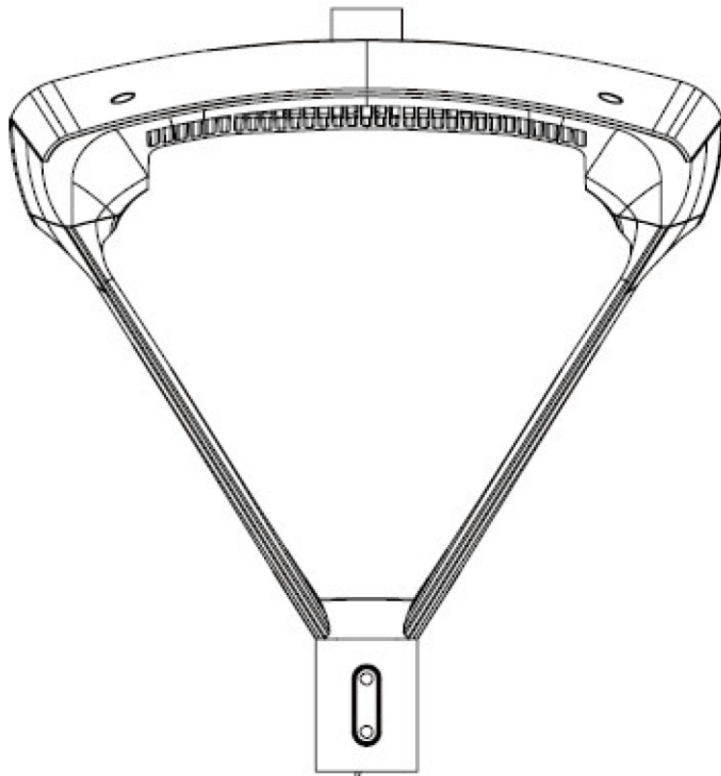

Dimmable cable

Blue is “+”

White is “-”



LED Garden Light Specification

YB-TP500 Series

VII. Package Information:

Item	G.W	N.W	Carton Size (MM)
YB-TP500-W050	15.9	13.9	615*595*490mm
YB-TP500-W100	16.0	14.0	615*595*490mm
YB-TP500-W150	16.2	14.2	615*595*490mm
YB-TP500-W200	16.6	14.6	615*595*490mm
YB-TP500-W300	17	15.0	615*595*490mm

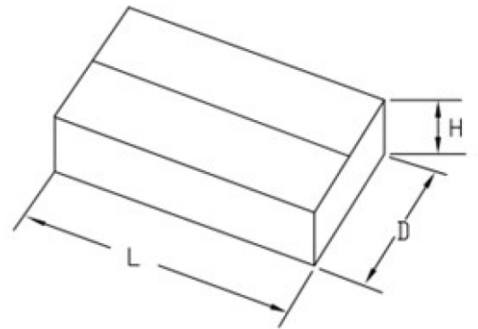
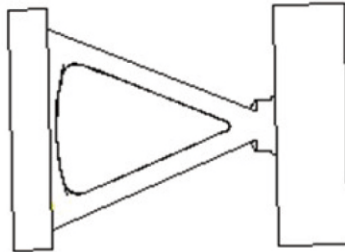
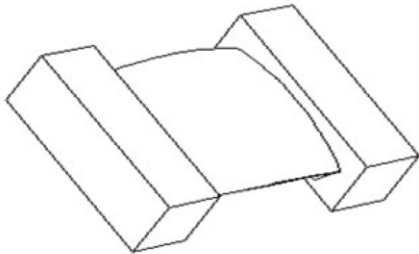

VIII. Installation Caution:

- 1、 Make sure the power has been turned off before maintenance.
 - 2、 Clean the lens cover regularly to maintain high transmission of light.
 - 3、 Clean up the dust from the reflector and heat sink regularly to keep sound heat dispersion.
 - 4、 Be careful not to use water or corrosive solution for cleaning, preferably with a dry cloth.
 - 5、 When install or replace power supply, directly open the back cover with a screwdriver, then remove the power supply. There are three-core cable of AC power, red corresponds to the power of “L”, blue to “N”, and green or yellow to “G” .
-